



Attractive Cigarette Receptacle

Installation Instructions for

Cigarette Receptacles - Floor Standing Model

AARGO
PRODUCTS INC.

Tools Needed

- Tape Measure
- Safety Glasses
- Safety Gloves
- Screw Driver
- Drill
- Level

Hardware Needed

- All parts included

Installation

1. Open box and take out parts.
2. Put Screw (1), Washer (2), Lock Washer (3) and large Washer (4) together.
3. Insert Weight (5) into Base (6) together, insert Screw and Washers into base.
4. Connect Base, Screw, Washers, Screw and Large Nut (7), tighten together.
5. Get Small Tube (8) attached to Base and Screws, add Large Washer (9) Small Washer (10), Lock Washer (11) and Nut (12) tighten together. (Base should be all connected at this time).
6. Insert Canister (13) to Base, push in Button and Canister will lock in place.
7. Insert Top (14) to Canister (13) push in Button and Top will lock in place.

See figure 1.

To Remove and Clean

1. Press Button on Top in and pull top off.
2. On Base push Button and lift.
3. Turn over Canister and Empty.

See figure 2.

Figure 1

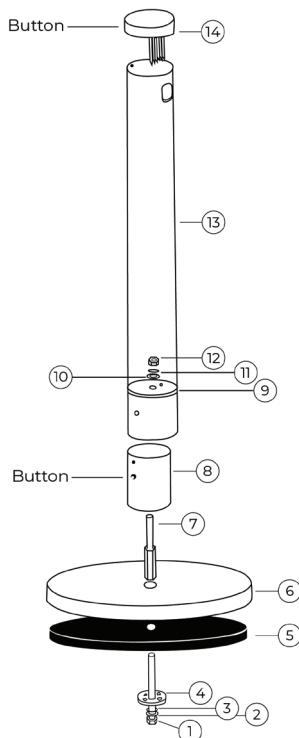
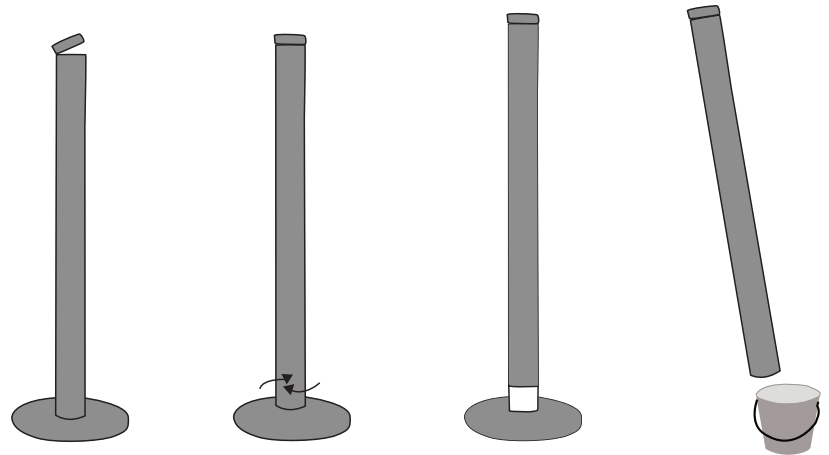

Figure 2



Parts Included

DESCRIPTION	QUANTITY
Scew	1
Washer	1
Lock Washer	1
Large Washer	1
Weight	1
Base	1
Large Nut	1
Small Tube	1
Small Washer	1
Canister	1
Top	1